



C-EL Adjustable Shaft-Run T-Fitting with Cone

24° Swivel (DIN EN ISO 8434-1) /
24° Tube Connection (DIN EN ISO 8434-1)



C-EL-M-WD

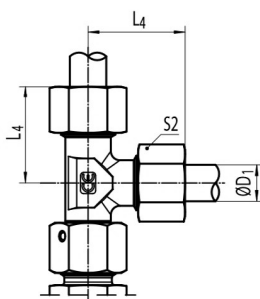
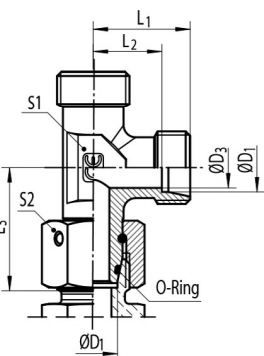

Series	PN [bar]		ØD ₁ [mm]	ØD ₃ [mm]	L ₁ [mm]	L ₂ [mm]	L ₃ [mm]	L ₄ [mm]	S ₁ [mm]	S ₂ [mm]	Ordering Code *	kg/100	
	C	CF											
L	315	500	6	4	19	12.0	26.0	27	12	14	C-EL 06 L OMD	3.7	
			8	6	21	14.0	27.5	29	12	17	C-EL 08 L OMD	5.0	
			10	8	22	15.0	29.0	30	14	19	C-EL 10 L OMD	6.4	
	315	400	12	10	24	17.0	29.5	32	17	22	C-EL 12 L OMD	8.2	
			15	12	28	21.0	32.5	36	19	27	C-EL 15 L OMD	15.1	
			18	15	31	23.5	35.5	40	24	32	C-EL 18 L OMD	20.5	
	160	250	22	19	35	27.5	38.5	44	27	36	C-EL 22 L OMD	27.0	
			28	24	38	30.5	41.5	47	36	41	C-EL 28 L OMD	39.6	
			35	30	45	34.5	51.0	56	41	50	C-EL 35 L OMD	60.4	
				42	36	51	40.0	56.0	63	50	60	C-EL 42 L OMD	89.1
	S	630	800	6	4	23	16.0	27.0	31	12	17	C-EL 06 S OMD	5.9
				8	5	24	17.0	27.5	32	14	19	C-EL 08 S OMD	7.7
10				7	25	17.5	30.0	34	17	22	C-EL 10 S OMD	10.3	
630		630	12	8	29	21.5	31.0	38	17	24	C-EL 12 S OMD	13.4	
			14	10	30	22.0	35.0	40	19	27	C-EL 14 S OMD	17.7	
400		630	16	12	33	24.5	36.5	43	24	30	C-EL 16 S OMD	23.3	
			20	16	37	26.5	44.5	48	27	36	C-EL 20 S OMD	35.1	
400		400	25	20	42	30.0	50.0	54	36	46	C-EL 25 S OMD	63.3	
			30	25	49	35.5	55.0	62	41	50	C-EL 30 S OMD	85.6	
			38	32	57	41.0	63.0	72	50	60	C-EL 38 S OMD	132.7	

*Replace the character "C" with "CF" when you require steel!
C = Stainless Steel, 1.4571 (Seal FKM) CF = Galvanized Steel Cr(VI)-free (Seal NBR)