

# C-G Connection Studs

Male Stud Connector  
24° Tube Connection (DIN EN ISO 8434-1)

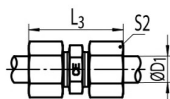
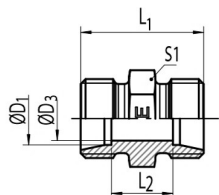

Series	PN [bar]		ØD <sub>1</sub> [mm]	ØD <sub>3</sub> [mm]	L <sub>1</sub> [mm]	L <sub>2</sub> [mm]	L <sub>3</sub> [mm]	S <sub>1</sub> [mm]	S <sub>2</sub> [mm]	Ordering Code *	kg/ 100
	C	CF									
LL	100	100	4	3.0	20	12	32	9	10	<b>C-G 04 LL X</b>	0.6
			6	4.5	20	9	32	11	12	<b>C-G 06 LL X</b>	0.7
			8	6.0	23	12	35	12	14	<b>C-G 08 LL X</b>	1.1
			10	8.0	23	12	35	14	17	<b>C-G 10 LL X</b>	1.3
			12	10.0	23	11	35	17	19	<b>C-G 12 LL X</b>	1.6
L	315	500	6	4.0	24	10	40	12	14	<b>C-G 06 LX</b>	1.3
			8	6.0	25	11	41	14	17	<b>C-G 08 LX</b>	1.6
			10	8.0	27	13	43	17	19	<b>C-G 10 LX</b>	2.5
	315	400	12	10.0	28	14	44	19	22	<b>C-G 12 LX</b>	2.8
			15	12.0	30	16	46	24	27	<b>C-G 15 LX</b>	4.8
			18	15.0	31	16	49	27	32	<b>C-G 18 LX</b>	6.7
	160	250	22	19.0	35	20	53	32	36	<b>C-G 22 LX</b>	8.9
			28	24.0	36	21	54	41	41	<b>C-G 28 LX</b>	13.5
			35	30.0	41	20	63	46	50	<b>C-G 35 LX</b>	21.0
			42	36.0	43	21	67	55	60	<b>C-G 42 LX</b>	29.6
S	630	800	6	4.0	30	16	46	14	17	<b>C-G 06 SX</b>	2.5
			8	5.0	32	18	48	17	19	<b>C-G 08 SX</b>	3.7
			10	7.0	32	17	50	19	22	<b>C-G 10 SX</b>	4.3
	630	630	12	8.0	34	19	52	22	24	<b>C-G 12 SX</b>	6.3
			14	10.0	38	22	58	24	27	<b>C-G 14 SX</b>	7.6
	400	630	16	12.0	38	21	58	27	30	<b>C-G 16 SX</b>	8.8
			20	16.0	44	23	66	32	36	<b>C-G 20 SX</b>	14.2
	400	400	25	20.0	50	26	74	41	46	<b>C-G 25 SX</b>	25.1
			30	25.0	54	27	80	46	50	<b>C-G 30 SX</b>	33.0
	250	400	38	32.0	61	29	91	55	60	<b>C-G 38 SX</b>	54.1

\*Replace the character "C" with "CF" when you require steel!  
**C** = Stainless Steel, 1.4571    **CF** = Galvanized Steel Cr(VI)-free